

VISCOSIMÈTRE

FICHE N° 406

PRÉSERVER
SAUVEGARDER
VALORISER

Période de fabrication : 2000-2024

Fabricant : Brookfield

Domaines : Santé

Sous-domaines : Pharmacologie

Organisme : Université de Rouen / UFR de médecine et pharmacie

Ville : Rouen

Modèle : LVDV-I+

Matériaux :

Description

Conservé dans une mallette, ce viscosimètre à affichage digital donne une lecture directe de la viscosité et du pourcentage de l'échelle de torsion. Cet appareil est équipé d'un clavier sensitif étanche, d'une sortie analogique pour table traçante ainsi que d'un mode d'arrêt programmable à un temps ou une vitesse donnée. Ce viscosimètre permet la mesure directe de la viscosité de liquides, gels, pommades, etc. Son principe de fonctionnement repose sur les forces de frottement s'exerçant sur un mobile de forme et de dimensions spécifiques tournant à l'intérieur de la substance. La rotation du mobile est assurée par un moteur électrique situé dans le corps de l'appareil. L'axe vertical de ce moteur est relié à l'axe du mobile par l'intermédiaire d'un ressort spirale qui s'écarte d'autant plus de sa position d'équilibre que les forces subies par le mobile sont importantes, et donc que la substance est visqueuse. C'est à partir de cet écartement que l'appareil calcule la viscosité.

Utilisation

Cet exemplaire est utilisé dans les travaux pratiques de physique des étudiants en 2e année à la faculté de pharmacie de l'Université de Rouen.







CE **BROOKFIELD**
 Model LVDV-1+
 Serial Number AT61946
 Voltage 230V~
 Frequency 50/60Hz
 Power 22 Watts
 LR99102
 BROOKFIELD ENGINEERING LABORATORIES, INC.
 11 Commerce Blvd. Middleboro, MA 02346
 (800) 628-8139 (508) 946-6200

LVDV1230
 AT61946

ANALOG OUTPUTS



CERTIFICATE NUMBER
240488



CALIBRATION DATE
AUGUST 3, 2000

CERTIFICATE OF VISCOMETER CALIBRATION

MODEL		SERIAL NUMBER	
LVDV-1+		AT61946	
REFERENCE EQUIPMENT			
INSTRUMENT	MODEL	SERIAL NUMBER	
NIST Fluid	LVT	MASTER 02	
	R400	99201	
TEMPERATURE SENSOR	m/v	210311	

CALIBRATION OF THIS INSTRUMENT WILL BE ACCURATE TO WITHIN 1% OF ITS FULL SCALE RANGE WHEN OPERATED ACCORDING TO CALIBRATION CONDITIONS AS SPECIFIED IN THE BROOKFIELD VISCOMETER/RHEOMETER INSTRUCTION MANUAL.
 THIS INSTRUMENT HAS BEEN INSPECTED AND FOUND TO CONFORM TO THE CALIBRATION SPECIFICATIONS FOR THE BROOKFIELD VISCOMETER/RHEOMETER. CALIBRATION HAS BEEN DETERMINED AGAINST A PRIMARY VISCOSITY STANDARD, TRACEABLE TO THE NATIONAL INSTITUTE OF STANDARDS & TECHNOLOGY. TEMPERATURE AND HUMIDITY WERE CONTROLLED WITHIN NORMAL LABORATORY LIMITS. THE INSTRUMENT IS FREE FROM MECHANICAL DEFECTS AND IS IN PROPER OPERATING CONDITION.

BROOKFIELD ENGINEERING LABORATORIES, INC.
Sherman C. Caswell
 SHERMAN C. CASWELL, RHEOLOGY SECTION

BROOKFIELD ENGINEERING LABORATORIES, INC.
 11 Commerce Blvd., Middleboro, MA 02346-1031 USA
 Tel: 508-946-6200 or 800-628-8139 Fax: 508-946-6262
 INTERNET: www.brookfieldengineering.com

CALIBRATED BY

821



BROOKFIELD ENGINEERING LABORATORIES, INC.
 11 Commerce Boulevard • Middleboro, MA 02346 USA
MODELS 5 & 5-E LABORATORY STANDS
PARTS IDENTIFICATION & INSTRUCTIONS
 TEL 508-946-6200 or 800-628-8139 (USA excluding Massachusetts)
 FAX 508-946-6262 INTERNET <http://www.brookfieldengineering.com>

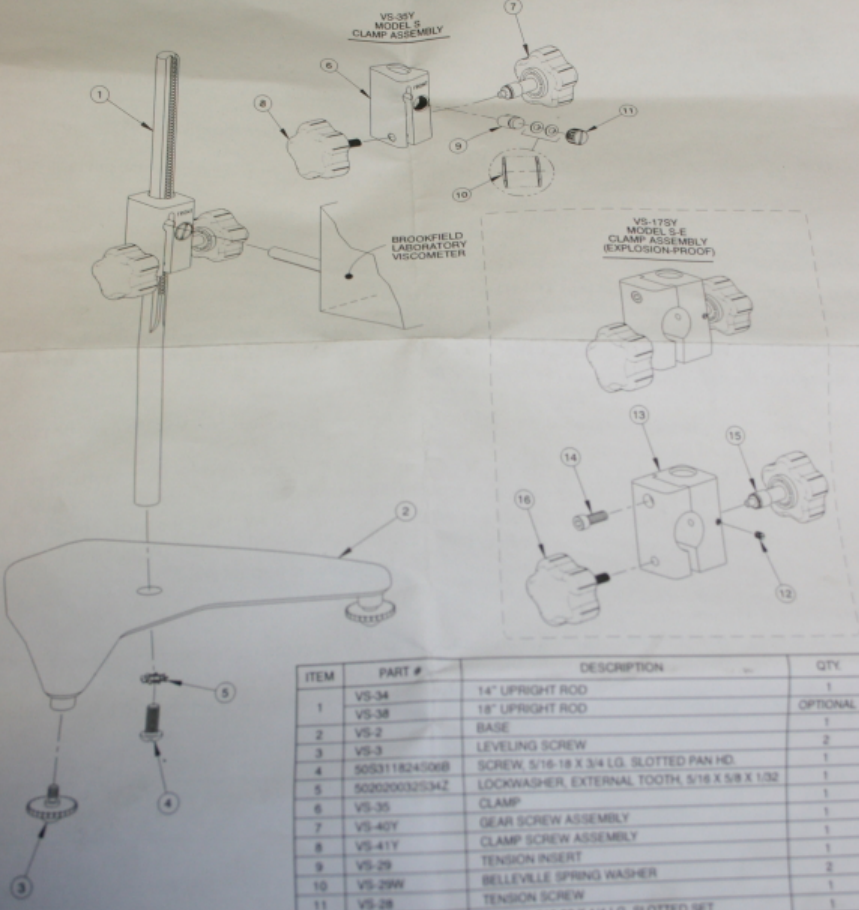

ITEM	PART #	DESCRIPTION	QTY
1	VS-34	14" UPRIGHT ROD	1
	VS-38	18" UPRIGHT ROD	OPTIONAL
2	VS-2	BASE	1
3	VS-3	LEVELING SCREW	2
4	505311824106B	SCREW, 5/16-18 X 3/4 LG. SLOTTED PAN HD.	1
5	502020032134Z	LOCKWASHER, EXTERNAL TOOTH, 5/16 X 5/8 X 1/32	1
6	VS-35	CLAMP	1
7	VS-40Y	GEAR SCREW ASSEMBLY	1
8	VS-41Y	CLAMP SCREW ASSEMBLY	1
9	VS-29	TENSION INSERT	1
10	VS-29W	BELLEVILLE SPRING WASHER	2
11	VS-28	TENSION SCREW	1
12	505103208521B	SCREW, #10-32 X 1 1/4 LG. SLOTTED SET	1
		CLAMP ASSEMBLY	1
13	VSXA-17Y	SCREW, 1/4-20 X 3/4 LG. SOC. HD. CAP. 18-8 SS	1
14	505252024E140	SCREW, 1/4-20 X 3/4 LG. SOC. HD. CAP. 18-8 SS	1
15	VS-46Y	MODEL 5-E GEAR SCREW ASSEMBLY	1
16	VS-46Y	MODEL 5-E CLAMP SCREW ASSEMBLY	1

EXPLOSION-PROOF CLAMP VS-17Y PARTS

**MODELS S & S-E LABORATORY STANDS
PARTS IDENTIFICATION & INSTRUCTIONS**

TEL 508-946-6200 or 800-628-8139 (USA excluding Massachusetts)
FAX 508-946-6262 INTERNET <http://www.brookfieldengineering.com>

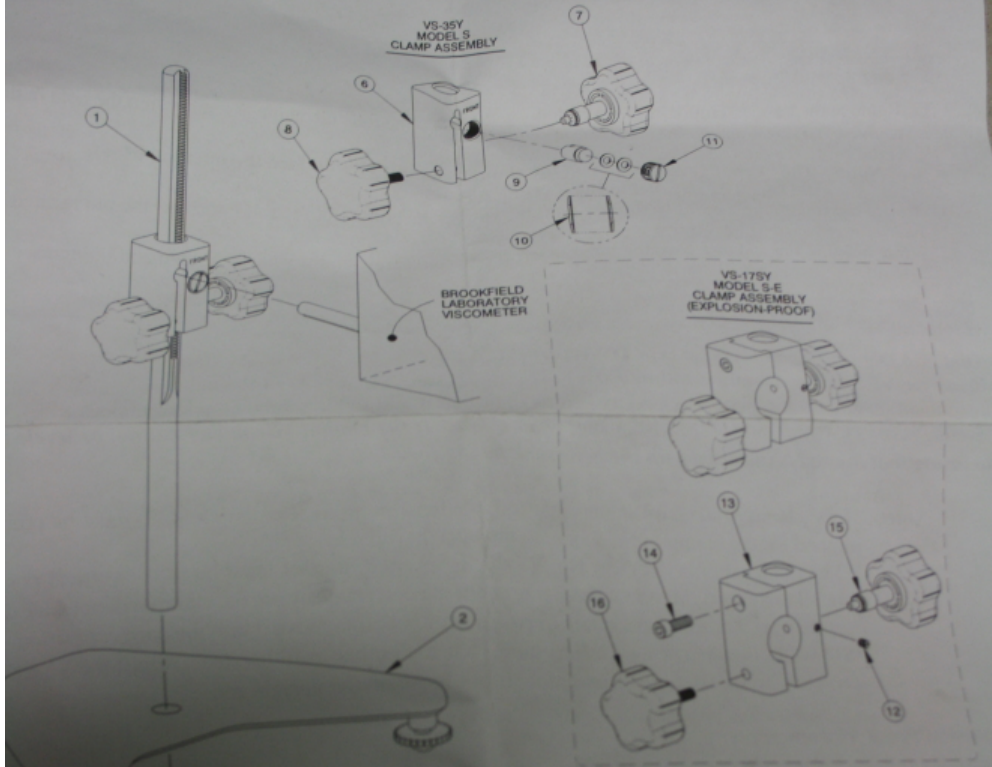

ITEM	PART #	DESCRIPTION	QTY.
1	VS-34	14" UPRIGHT ROD	1
	VS-36	18" UPRIGHT ROD	OPTIONAL
2	VS-2	BASE	1
3	VS-3	LEVELING SCREW	2
4	5053118245088	SCREW 5/16-18 X 3/4 LG. SLOTTED PAN HD.	1
5	5020200325342	LOCKWASHER, EXTERNAL TOOTH, 5/16 X 5/8 X 1/32	1
6	VS-35	CLAMP	1
7	VS-40Y	GEAR SCREW ASSEMBLY	1
8	VS-41Y	CLAMP SCREW ASSEMBLY	1
9	VS-29	TENSION INSERT	1
10	VS-29W	BELLEVILLE SPRING WASHER	2
11	VS-38	TENSION SCREW	1
12	5051332085218	SCREW #10-32 X 1/4 LG. SLOTTED SET	1
13	VSXA-17Y	CLAMP ASSEMBLY	1
14	505202248140	SCREW 1/4-20 X 3/4 LG. SOC. HD. CAP. 18-8 SS	1
15	VS-46Y	MODEL S-E GEAR SCREW ASSEMBLY	1
16	VS-40Y	MODEL S-E CLAMP SCREW ASSEMBLY	1

EXPLOSION-PROOF
CLAMP VS-17Y PARTS

UNPACKING

Check carefully to see that all the components are received with no concealed damage.

1. Item: VS-2, with 2 Leveling Screws, VS-3, packed in a cardboard carton
1. Upper Rod, VS-14, with 1 Lockwasher
1. Pin, VS-17, with 1 Lockwasher
1. Pin, VS-18, with 1 Lockwasher
1. Pin, VS-19, with 1 Lockwasher
1. Pin, VS-20, with 1 Lockwasher
1. Pin, VS-21, with 1 Lockwasher
1. Pin, VS-22, with 1 Lockwasher
1. Pin, VS-23, with 1 Lockwasher
1. Pin, VS-24, with 1 Lockwasher
1. Pin, VS-25, with 1 Lockwasher
1. Pin, VS-26, with 1 Lockwasher
1. Pin, VS-27, with 1 Lockwasher
1. Pin, VS-28, with 1 Lockwasher
1. Pin, VS-29, with 1 Lockwasher
1. Pin, VS-30, with 1 Lockwasher
1. Pin, VS-31, with 1 Lockwasher
1. Pin, VS-32, with 1 Lockwasher
1. Pin, VS-33, with 1 Lockwasher
1. Pin, VS-34, with 1 Lockwasher
1. Pin, VS-35, with 1 Lockwasher
1. Pin, VS-36, with 1 Lockwasher
1. Pin, VS-37, with 1 Lockwasher
1. Pin, VS-38, with 1 Lockwasher
1. Pin, VS-39, with 1 Lockwasher
1. Pin, VS-40, with 1 Lockwasher
1. Pin, VS-41, with 1 Lockwasher
1. Pin, VS-42, with 1 Lockwasher
1. Pin, VS-43, with 1 Lockwasher
1. Pin, VS-44, with 1 Lockwasher
1. Pin, VS-45, with 1 Lockwasher
1. Pin, VS-46, with 1 Lockwasher
1. Pin, VS-47, with 1 Lockwasher
1. Pin, VS-48, with 1 Lockwasher
1. Pin, VS-49, with 1 Lockwasher
1. Pin, VS-50, with 1 Lockwasher
1. Pin, VS-51, with 1 Lockwasher
1. Pin, VS-52, with 1 Lockwasher
1. Pin, VS-53, with 1 Lockwasher
1. Pin, VS-54, with 1 Lockwasher
1. Pin, VS-55, with 1 Lockwasher
1. Pin, VS-56, with 1 Lockwasher
1. Pin, VS-57, with 1 Lockwasher
1. Pin, VS-58, with 1 Lockwasher
1. Pin, VS-59, with 1 Lockwasher
1. Pin, VS-60, with 1 Lockwasher
1. Pin, VS-61, with 1 Lockwasher
1. Pin, VS-62, with 1 Lockwasher
1. Pin, VS-63, with 1 Lockwasher
1. Pin, VS-64, with 1 Lockwasher
1. Pin, VS-65, with 1 Lockwasher
1. Pin, VS-66, with 1 Lockwasher
1. Pin, VS-67, with 1 Lockwasher
1. Pin, VS-68, with 1 Lockwasher
1. Pin, VS-69, with 1 Lockwasher
1. Pin, VS-70, with 1 Lockwasher
1. Pin, VS-71, with 1 Lockwasher
1. Pin, VS-72, with 1 Lockwasher
1. Pin, VS-73, with 1 Lockwasher
1. Pin, VS-74, with 1 Lockwasher
1. Pin, VS-75, with 1 Lockwasher
1. Pin, VS-76, with 1 Lockwasher
1. Pin, VS-77, with 1 Lockwasher
1. Pin, VS-78, with 1 Lockwasher
1. Pin, VS-79, with 1 Lockwasher
1. Pin, VS-80, with 1 Lockwasher
1. Pin, VS-81, with 1 Lockwasher
1. Pin, VS-82, with 1 Lockwasher
1. Pin, VS-83, with 1 Lockwasher
1. Pin, VS-84, with 1 Lockwasher
1. Pin, VS-85, with 1 Lockwasher
1. Pin, VS-86, with 1 Lockwasher
1. Pin, VS-87, with 1 Lockwasher
1. Pin, VS-88, with 1 Lockwasher
1. Pin, VS-89, with 1 Lockwasher
1. Pin, VS-90, with 1 Lockwasher
1. Pin, VS-91, with 1 Lockwasher
1. Pin, VS-92, with 1 Lockwasher
1. Pin, VS-93, with 1 Lockwasher
1. Pin, VS-94, with 1 Lockwasher
1. Pin, VS-95, with 1 Lockwasher
1. Pin, VS-96, with 1 Lockwasher
1. Pin, VS-97, with 1 Lockwasher
1. Pin, VS-98, with 1 Lockwasher
1. Pin, VS-99, with 1 Lockwasher
1. Pin, VS-100, with 1 Lockwasher

ASSEMBLY

1. Remove the base assembly from the carton.
2. Remove the screw and washer from the upright rod. Place the rod and clamp assembly into the hole in the top of the base.
3. Rotate the rod/clamp assembly slightly until the slot on the bottom of the rod intersects the pin located in the top of the base. **Note: The "front" designation on the clamp assembly should face the opening of the top hole, parallel to the slot on the bottom of the rod.**
4. While holding the rod and base together, insert the slotted screw and washer as shown and tighten securely.

VISCOSIMETER MOUNTING

Dial and Digital Viscosimeters (except DV-II Rheometers): Adjust the mounting rod into the hole (with the cut-away slot) in the clamp assembly. Use the instrument level until the bubble is centered from right to left and tighten the clamp screws. **Note: If the Digital Viscosimeter cannot be leveled, check the mounting rod and is installed with the gear track facing forward.**

Note: If the clamp is taken off the upright rod, the tension insert (Part No. VS-29) must be properly aligned for the clamp to fit back onto the upright rod. When the tension insert (Part No. VS-29) is inserted, its slot must be in the vertical position parallel to the upright rod. If the slot is not in the correct position, the clamp will not slide down over the upright rod. Use a small screwdriver or pencil to move it into the correct position. The VS-298 Belleville spring washers must face each other as illustrated. Adjust the VS-28 tension screws so that the clamp assembly is not loose on the upright rod.

Caution: Do not tighten the clamp knobs unless the viscosimeter mounting rod is inserted in the clamp assembly.

Center the Viscosimeter relative to the stand base and retighten the jam nut as required. Referring to the Viscosimeter bubble level, adjust the leveling screws until the instrument is level.

Pour nous citer :
Base de la Mission nationale de sauvegarde et de valorisation du patrimoine scientifique et technique contemporain, PATSTEC, Viscosimètre (Brookfield),
<https://www.patstec.fr/ressources/objets/detail?id=20201>, consulté le 2026-04-21